

# Overall Dimensions

4 Products + UHF, Suction or STP,  
with Vap. Rec. & Preset

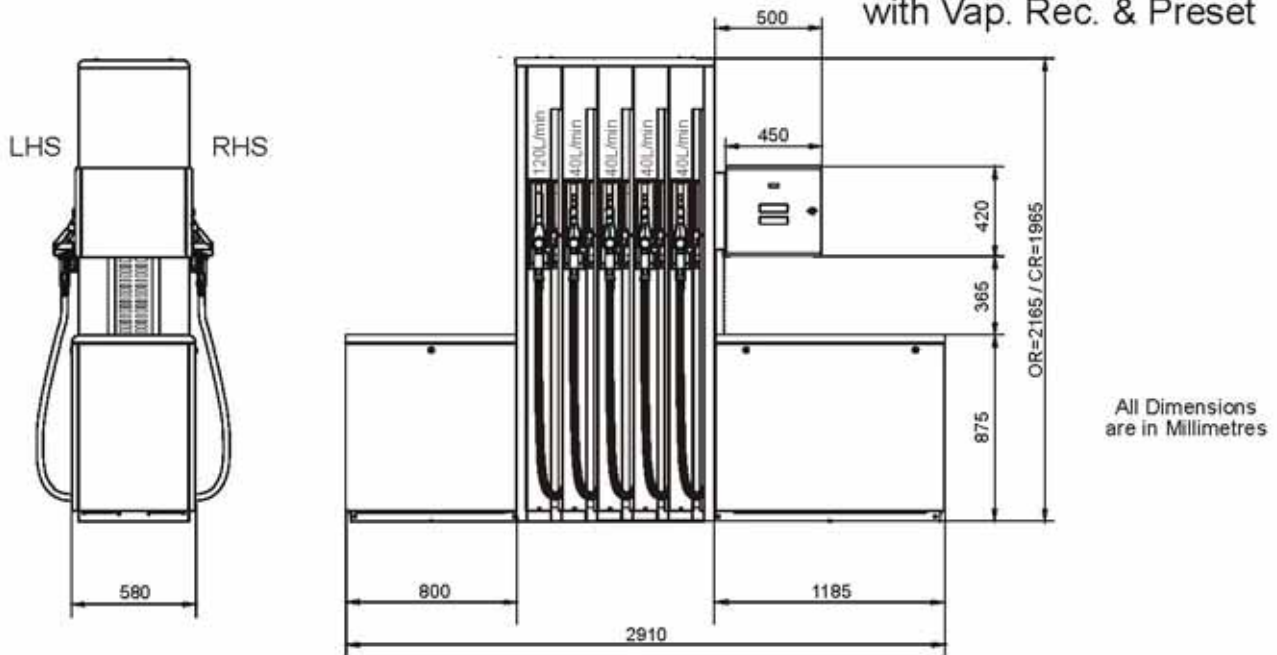

Option: Suction connection kit  
140 826 683 For GPU-90  
140 838 943 For GDP-120

# Footprint Details

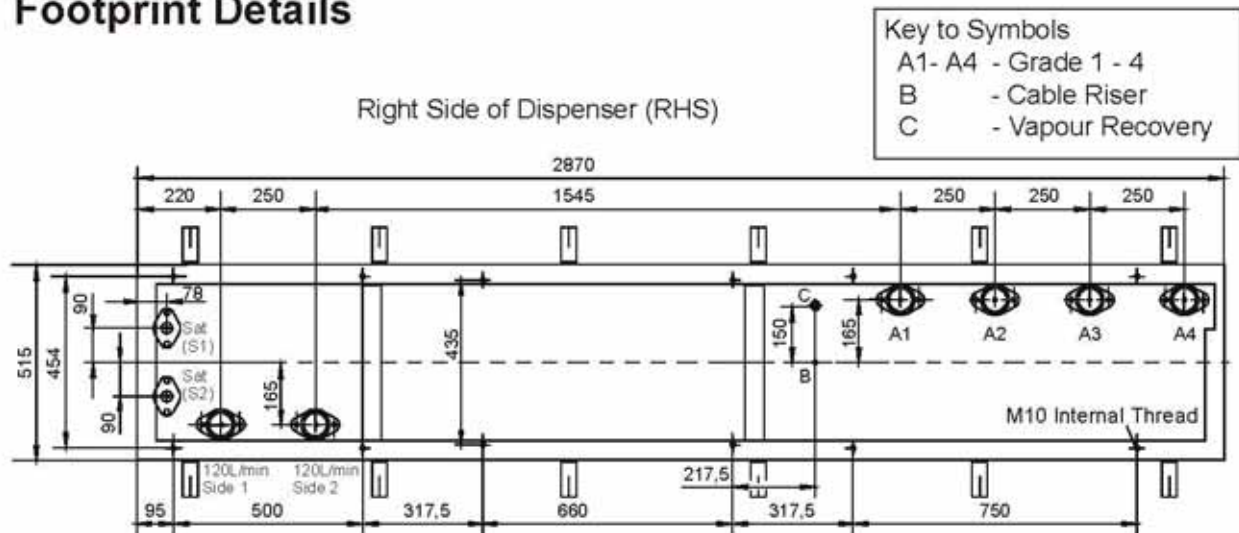

Subframe  
Part No. - 140 893 231

Left Side of Dispenser (LHS)

It is recommended that Vapour Recovery return pipes  
are installed where this may be a future requirement.

# Module Configuration and Maximum Current

**Suction Pump**  
Motor supply maximum current  
1 Phase Versions, 230V = 12,5 Amps  
3 Phase Versions, 230V = 10,5 Amps  
3 Phase Versions, 400V = 6,0 Amps  
Electronic supply maximum current  
All Versions = 3,0 Amps

**Submerge Turbine Pump (STP)**  
Vapour Recovery maximum current  
3 Phase Motors = 1,0 Amps  
1 Phase Motors = 3,0 Amps  
Electronic supply maximum current  
All Versions = 3,0 Amps

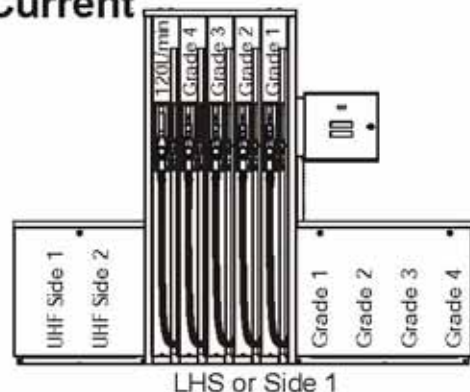
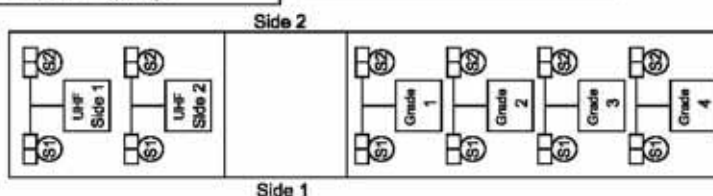



**НЕФТЕ  
ПРОДУКТ  
ТЕХНИКА**

**ЗАО «НЕФТЕПРОДУКТТЕХНИКА»**  
Россия, 119334, Москва, ул. Бардына, 6/30  
Тел./факс: (495) 725-04-34  
<http://www.neftprod.ru>  
e-mail: [mf@neftprod.msk.ru](mailto:mf@neftprod.msk.ru)

*Оборудование для АЗС*  
Официальный дистрибьютор

